

62 Blackstone Drive
Raymond, NH 03077

kw METROPOLITAN
KELLERWILLIAMS. REALTY
BEDFORD

Powered by **homes.unionleader.com**

MLS# 4793175

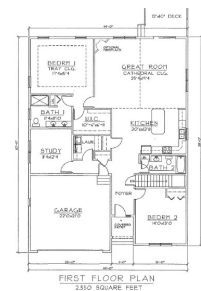

\$ 449,900

2 Bedrooms . 1 Bathroom . 2,088 Sqft

Location, location, location! Welcome to Phase 2 at Blackstone Reserve, your gateway from the City to the Seacoast. Located just one mile from Exit 4, Route 101 is where you will find this luxurious 55+ active adult community. Blackstone Reserve offers a natural picturesque setting featuring 66 single-family detached condos. Residents will enjoy a low maintenance environment giving you time to enjoy a social climate defined by community living. Each home at Blackstone Reserve provides open-concept, one level living at its best. The comfortable floor plans range between 1,710 square feet to 2,232 square feet and feature 2 bedrooms, 2 bathrooms, master bedroom with en suite, study/office, 2 car attached garages, and full basements. Standard features include: cathedral ceilings, hardwood floors, granite countertops, stainless steel appliances, high-end cabinetry, central A/C and so much more! Homeowners make selections to customize and personalize each home to fit their lifestyle and color preferences. Prices start at \$384,900. Model Home OPEN Wednesday-Sunday from 10AM-4PM. By appointment. Unit 11 can be the Chateau however we can put any model on this lot. Sunroom is optional.



Frank DiDonato

PHONE
603-232-8282