

**16 Blackstone Drive**  
Raymond, NH 03077

**kw** METROPOLITAN  
KELLERWILLIAMS. REALTY  
**BEDFORD**

Powered by **homes.unionleader.com**

**MLS# 4772026**

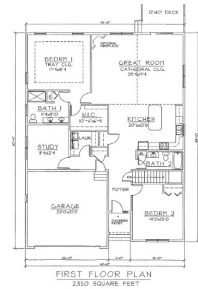

DREAM HOME

THE KELLERWILLIAMS GROUP

**\$ 429,900**

**2 Bedrooms . 1 Bathroom . 2,088 Sqft**

Location, location, location! Welcome to Blackstone Reserve, your gateway from the City to the Seacoast. Located just one mile from Exit 4, Route 101 is where you will find this luxurious 55+ active adult community. Blackstone Reserve offers a natural picturesque setting featuring 66 single-family detached condos. Residents will enjoy a low maintenance environment giving you time to enjoy a social climate defined by community living. Each home at Blackstone Reserve provides open-concept, one level living at its best. The comfortable floor plans range between 1,710 square feet to 2,232 square feet and feature 2 bedrooms, 2 bathrooms, master bedroom with en suite, 2 car attached garages, and full basements. Standard features include: cathedral ceilings, hardwood floors, granite countertops, stainless steel appliances, high-end cabinetry, central A/C and so much more! Homeowners make selections to customize and personalize each home to fit their lifestyle and color preferences. Prices start at \$374,900. Stop by Wednesday - Sunday from 10AM-4PM or call for an appointment. Unit 46 will be the Chateau however we can put any model on this lot. Sunroom is optional. Other floor plans and options are available on any of the lots. This project has received full approval from the NH Attorney General's...



**Frank DiDonato**

PHONE

**603-232-8282**